

User Manual

Model: TLL151081

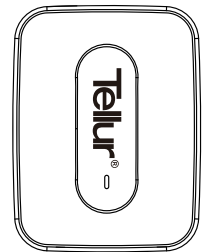

25W 3 Ports QC 3.0 CHARGER

1. Product Overview

1.1 Introduction

1.2 Accessories

2. Appearance Description

2.1 Technical Parameters

2.2 Protection

2.3 Material

2.4 Appearance and Interface

3. Operation Instructions

Thank you for choosing QC 3.0 Charger.
Please read carefully our User Manual before using it, if you have any problem when using, please contact our customer service, we'll solve it as soon as possible.
Any suggestion is welcomed.

1. Product Overview

1.1 Introduction

◆ Qualcomm® quick charge 3.0 charger

◆ 25W (3.6V-6.5V)dc/ 3A, (6.5V-9V)dc/2A, (9V-12V)dc/1.5A

Qualcomm® quick charge3.0 technology:

Up to 4X faster than standard chargers, able to charge compatible devices to 80%in just 35 minutes, using the USB port with QC 3.0 technology and compatible cable, the voltage flexible change from 3.6V to 12V.

◆ Backwards compatible with all versions of Qualcomm Quick Charge technology (1.0, 2.0 & 3.0).

◆ Provides standard charging for non-Quick Charge devices.

◆ Full speed charging 3 devices at the same time

◆ Efficient synchronous rectification scheme, up to 87% of the conversion rate.

◆ Elegant, durable, heat eliminable.

◆ Over-load, over-voltage, over-current and short circuit protection.

◆ Compact and unique appearance design by our own, without any gap.

◆ Guaranteed Safety: Premium materials and built-in fail-safes keep you and your device protected against shorts and surges.

◆ With 3 pcs Smart IC.

1.2 Accessories

◆ 25W 3 ports USB CHARGER

◆ User Manual

2. Appearance Description

2.1 Technical Parameters

◆ Input Voltage: AC 100-240V

◆ Quiescent Current: < 300mW

◆ QC 3.0 Output: (3.6V-6.5V)/ 3A, (6.5V-9V)/2A, (9V-12V)/1.5A

◆ Output port 2: max 2.4A with smart IC

◆ Output port 3: max 2.4A with smart IC

◆ Max Output Current: 5V/5000mA

◆ Max Power: 25W

◆ Highest Efficiency: 87%

2.2 Protection

◆ Output Short Circuit Protect: To avoid continuing charging devices automatically, on short circuit protection situation, our item will stop charging to protect devices

◆ Over Voltage Protection: If Voltage $\geq 6.2V$, protection system will be started

◆ High Temperature of main components is higher than 125℃ (housing temperature $\geq 58℃$), protection system will be started. If temperature of main components less than 60℃, it will resume working.

2.3 Material

Plastic Housing: PC+Fireproof material

2.4 Appearance and Interface

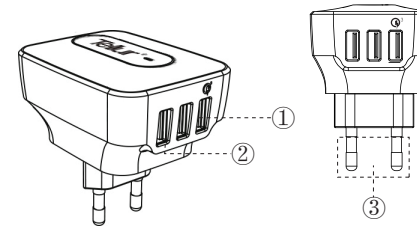

① Qualcomm quick charge 3.0 charging port: (3.6V-6.5V)3A,(6.5V-9V)2A,(9V-12V)1.5A

② Intelligent identification of charging port, max output 2.4A, could charge all 5V like Iphone/Ipad/Samsung Tablet/Power Bank etc at full speed.

③ Compatible for different country Household Electricity.

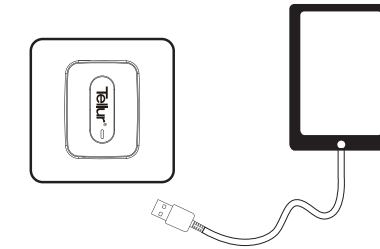

3. Operation Instruction

◆ As above picture showed, connect to alternating current AC 100-240V , then 25W 3 ports QC 3.0 CHARGER will work. If without loading, its internal consumption is about 100mW.

◆ There is smart IC in each charging port, will identify charging current automatically, no need to distinguish charging port for Samsung/Apple etc. It's the best technology to realize real intelligent charging at full speed.

⚠ Our item is suitable to use in AC 100-240V constant alternating current, if higher or lower voltage is unsuitable

Contact us:

E-mail: office@tellur.ro

Web: www.tellur.ro

Adress: Marinariilor Street no.29,

Bucharest, Romania

Phone: +40 21 233 09 95

